

# TAP9101 – Cubic

Key:	Description:	APX size (mm):	Base material:	Colour:	QTY:
A1	Aerator housing	10 x 30 x 11	Rubber	Grey	1
A2	Aerator	7 x 26 x 9	Plastic	White	1
A3	Spout	21 x 265	Brass	Chrome	1
A4	Anti friction ring	25 x 2.5	PTFE	White	1
A5	O-ring	21 OD x 1.5	Rubber	Black	1
A6	O-ring	21 OD x 1.5	Rubber	Black	1
A7	Grub screw	M5 x 6.2	Brass	Brass	1
B1	Body	120 x 50	Brass	Chrome	1
C1	Valve cartridge	60 x 35	Plastic	Blue	1
C2	Handle stop	11 x 10	Brass	Brass	1
C3	Valve locking nut	37 x 12	Brass	Brass	1
C4	Valve shroud	42 x 13	Brass	Brass	1
C5	Handle body	50 x 32	Brass	Chrome	1
C6	Grub screw	M6 x 16	Steel	Silver	1
C7	o-ring	12 x 1	Rubber	Black	1
C8	Handle stem	10 x 90	Brass	Chrome	1
D1	Upper seal	50 x 1	Rubber	Black	1
D2	Fixing stud	120 x 8	Steel	Silver	1
D3	Stabiliser plate	88 x 58	Plastic	White	1
D4	Lower gasket	45 x 3.5	Rubber	Black	1
D5	Metal horseshoe	51 x 5	Steel	Silver	1
D6	Fixing nut	18 x 11 AF	Brass	Brass	1
E1	Hot inlet pipe	M12 x 260 x ½" BSP M	Stainless steel/Brass	Silver/red	1
E2	Cold inlet pipe	M12 x 260 x ½" BSP M	Stainless steel/Brass	Silver/blue	1
E3	Non return valve	16 x 14	Plastic	White	1
X1	Spout fixing kit assembly	N/A	N/A	N/A	1
X2	Fixing kit assembly	N/A	N/A	N/A	1
X3	Handle assembly	N/A	N/A	N/A	1

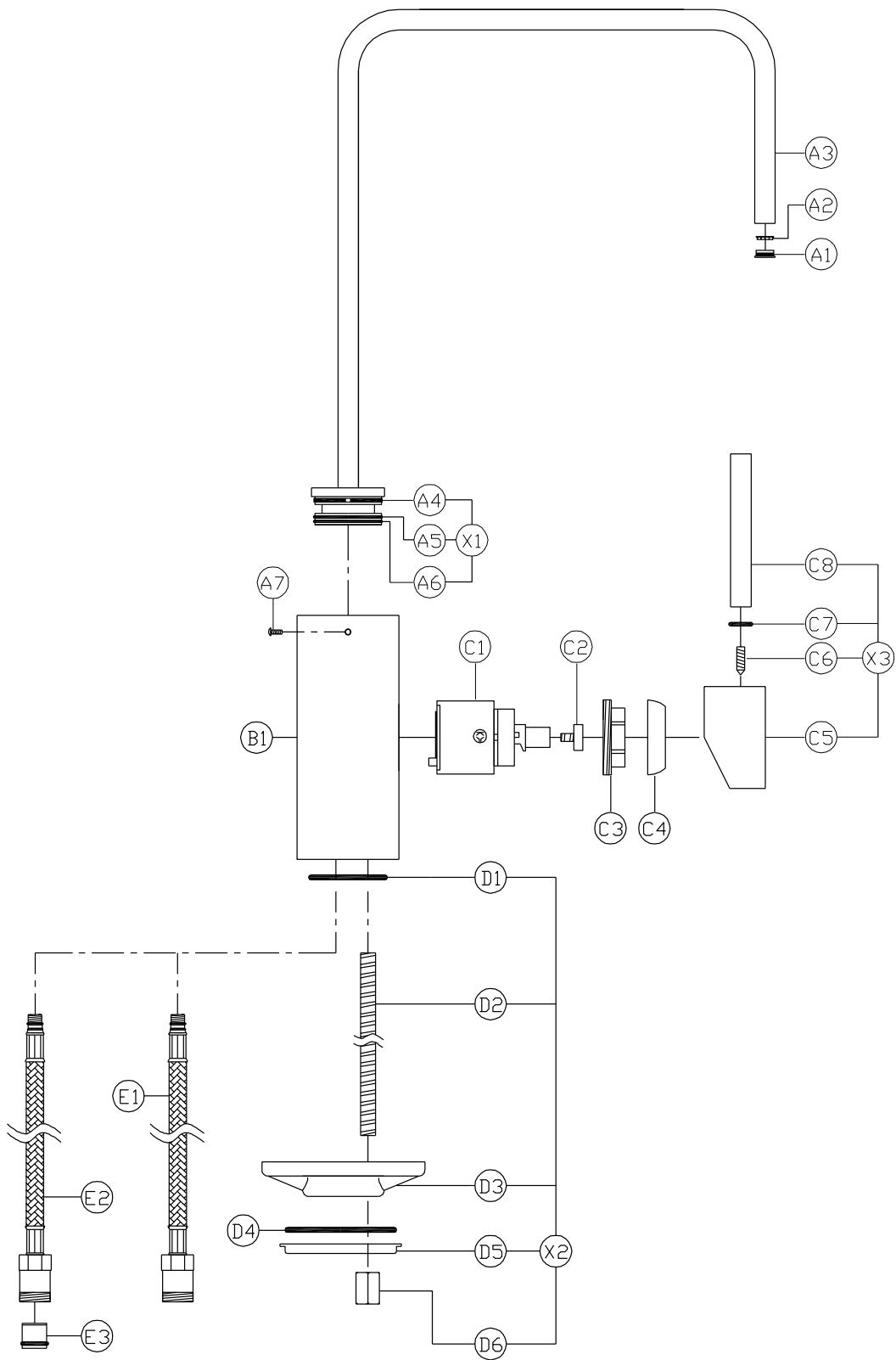

# TAP9101 - Cubic tap service drawing v1

(c) abode home products ltd  
www.abode.eu

our policy is to continually  
improve and develop products,  
and accordingly we reserve the  
right to amend specifications  
without prior notice

**General Advice:**

- These instructions are intended as a guide only, if you are in any doubt you should seek the advice of a qualified professional.
- Take care not to mark finished parts with screwdrivers or other tools.
- Use a pair of rubber gloves to get a better grip on decorative hand tight parts.
- Ensure all parts are reassembled tightly.
- After maintenance test that all assemblies are water tight and function correctly.
- Always isolate the hot and cold water supplies before starting any maintenance, once isolated you should drain any residual water from your system.

**To replace the valve:**

1. Unscrew the handle stem (C8).
2. Loosen grub screw (C6) using a 3mm A/F Allen key.
3. Pull the handle body (C5) horizontally away from the body (B1).
4. Unscrew the valve cover (C4).
5. Hold the body of the tap (B1) firmly. Using an adjustable spanner unscrew the valve lock nut (C3).
6. Unscrew the handle stop (C2).
7. Pull the old valve cartridge (C1) away from the tap.
8. Ensure that the body chamber (B1) is clean of dirt and grit.
9. Place the new valve (C1) in the chamber (B1), ensuring the locators on the base of valve (C1) align with the recesses in the chamber of the tap (B1).
10. Reassemble the tap in the reverse order.

**To replace the spout o-rings:**

1. Loosen grub screw (A7) on the rear of body (B1) using a 2.5mm A/F allen key.
2. Pull the spout (A3) vertically away from the body (B1).
3. Remove the old o-rings (A5 & A6) using a small screwdriver or similar.
4. If worn, remove the white PTFE spacer (A4).
5. Ensure the inside of the body (B1) and the spout base is clean of dirt and grit with a soft wet cloth.
6. If required locate the new white PTFE spacer (A4).
7. Carefully locate the new O-rings (A5 & A6) onto the spout base (A3).
8. Grease the O-rings thoroughly with silicone or alternative similar grease.
9. Reassemble the tap in the reverse order.